

DREO

Smart Pedestal Air Circulator Fan
PolyFan 613S

USER MANUAL

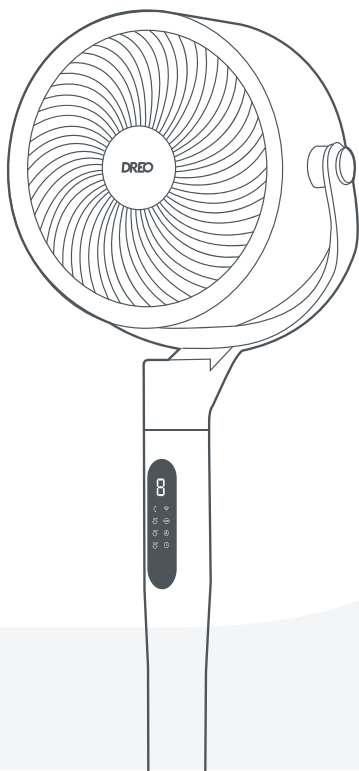

www.dreo.com

Looking for help?

Contact us to get expert support.



support@dreo.com



[\(888\) 290-1688](tel:(888)290-1688)



www.dreo.com

Mon - Fri, 9:00 am-5:00 pm PST/PDT

//

Thanks for Choosing **DREO!**

Your support means the world to us.
We hope you enjoy our product as
much as we did creating it.

CONTENTS

01

**IMPORTANT SAFETY
INSTRUCTIONS**

1-3

03

**CONNECTING TO
YOUR PEDESTAL
AIR CIRCULATOR
PolyFan 613S**

7

05

**USING YOUR PEDESTAL
AIR CIRCULATOR**

10-14

07

TROUBLESHOOTING

18

02

**ASSEMBLING YOUR
PEDESTAL AIR
CIRCULATOR**

4-6

04

**KNOWING YOUR
PEDESTAL AIR
CIRCULATOR**

8-9

06

**CLEANING
AND MAINTENANCE**

15-17

08

**DREO CUSTOMER
CARE**

19-20

IMPORTANT SAFETY INSTRUCTIONS

01



READ ALL CAUTIONARY MARKINGS ON THE APPLIANCE AND SAFETY INSTRUCTIONS IN THE USER MANUAL BEFORE USE.

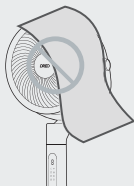

Do not cover the air inlet and outlet while in operation.



Do not use the air circulator near flammables and combustibles.

General Safety

1. Children shall not play with the appliance. Cleaning and maintenance shall not be performed by children without supervision.
2. Use the appliance as described in the user manual only. Any other use not recommended in the user manual may cause fire, electrical shock, or personal injury.
3. This appliance can be used by children aged above 8 years and persons with reduced physical, sensory or mental capabilities or lack of experience and knowledge if they have been given supervision or instruction concerning use of this appliance in a safe way and understand the hazards involved.

Operation Safety

1. Place the appliance on a flat, dry surface before use.
2. **Do not** immerse in water and any other liquids.
3. **Do not** use the appliance until the base is installed.
4. **Do not** insert your fingers, pencil and any other objects into the grilles under any circumstances
5. **Do not** dismantle, repair, or modify. All servicing should be performed by qualified personnel.
6. **Do not** operate the unit close to the curtain. **Do not** hang foreign objects on the grille to prevent damaging the balance of the fan or rotational structure.

7. **Do not** operate the fan under overly humid, high-temperature, dusty environment or the place where acid or alkali is stored.
 8. Fans should never blow directly on infant, the elderly and patients for a long time.
 9. When the unit is not operated during maintenance period, please cut off the power and then unplug the power plug.
 10. Do not pull the power with wet hands.
 11. Do not put or install the fan on the oblique plane to prevent inclination or other abnormal phenomenon.
 12. During the operation process, do not insert your fingers or sharp objects into grille to prevent personal injury or damage to the fan.
 13. Do not operate the fan under overly humid, high-temperature, dusty environment or the place where acid or alkali is stored.
- Do not operate the unit close to fire source or inflammable objects.

Electricity Safety

WARNING:

1. Make sure that the voltage of your electricity supply is the same as that indicated on the appliance.
2. Always unplug before cleaning or leaving the appliance unused for a long period of time. Keep your hands dry when plugging / unplugging.
3. Do not operate any air circulator with a damaged cord or plug. Discard a circulator or return to an authorized service facility for examination and/or repair.
4. Do not run cord under carpeting. Do not cover cord with throw rugs, runners, or similar coverings. Do not route cord under furniture or appliances. Arrange cord away from traffic area and where it will not be tripped over.
5. **WARNING:** To reduce the risk of fire or electric shock, do not use this air circulator with any solid-state speed control device.
6. Use 24V/1.5A power adapter only. Turn off the appliance before plugging.
7. **WARNING:** To reduce the risk of fire, electric shock or injury to persons, do not use replacement parts that have not been recommended by the manufacturer (e.g. parts made at home using a 3D printer).
8. If the supply cord is damaged, it must be replaced by the manufacturer or its service agent or a similarly qualified person in order to avoid a hazard.
9. **WARNING:** To reduce the risk of fire, electric shock and injury to persons, the unit body must be installed with the chassis that are marked (on their cartons) to indicate the suitability with this model. Other chassis cannot be substituted.

FOR HOUSEHOLD USE ONLY

READ AND SAVE THESE INSTRUCTIONS

Gentle Reminder:



Check the appliance regularly and refer to TROUBLESHOOTING or contact our customer support if it shows any of the following signs:

- Power cord or plug is damaged.
- Loud noise, unusual smell or excessive heat.

Specifications

Model No.	DBAF03S
Power Supply	24V $\overline{\text{=}}$ 1.5A
Rated Power	36W
Power Adapter	Input: 120V~60Hz 1.0A Output: 24V $\overline{\text{=}}$ 1.5A
Battery Type	CR2025 3V

ASSEMBLING YOUR PEDESTAL AIR CIRCULATOR

02

Assembly Instructions

When using the appliance for the first time, remove the wraps and attach the parts by following the steps below.

1

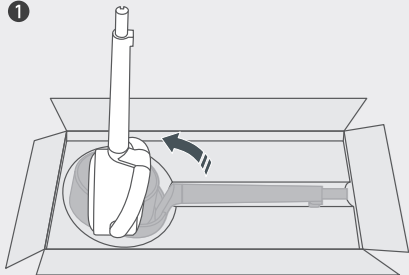

Position the pedestal air circulator fan upside down on the foam, aligning it with the fan head slot, for a convenient and secure installation.

2

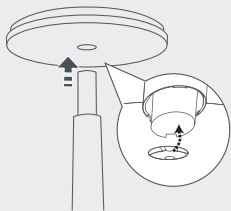

Push the pedestal air circulator fan into the base by aligning the cutout on the bottom of the pedestal air circulator fan with the jutting point in the middle of the base.

3

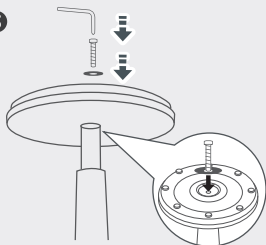

Thread the screw through the flat washer, insert into the base, and use the included screwdriver to drive the screw into the bottom of the pedestal air circulator fan.

4

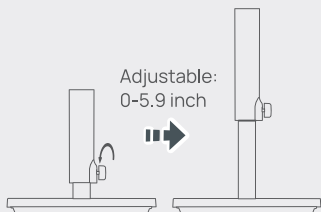

Turn the pedestal air circulator fan right side up. Hold the main body while rotating the Adjustment Collar counterclockwise to raise or lower the air circulator to the desired height.

5

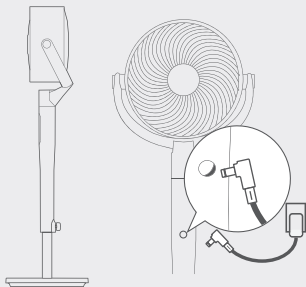

Tighten the adjustment collar by rotating clockwise. Plug the power adapter into the power (located at the back of the air circulator), and into the power outlet.



CAUTION

Do not operate the air circulator if the base has not been installed.

Package Contents

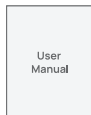
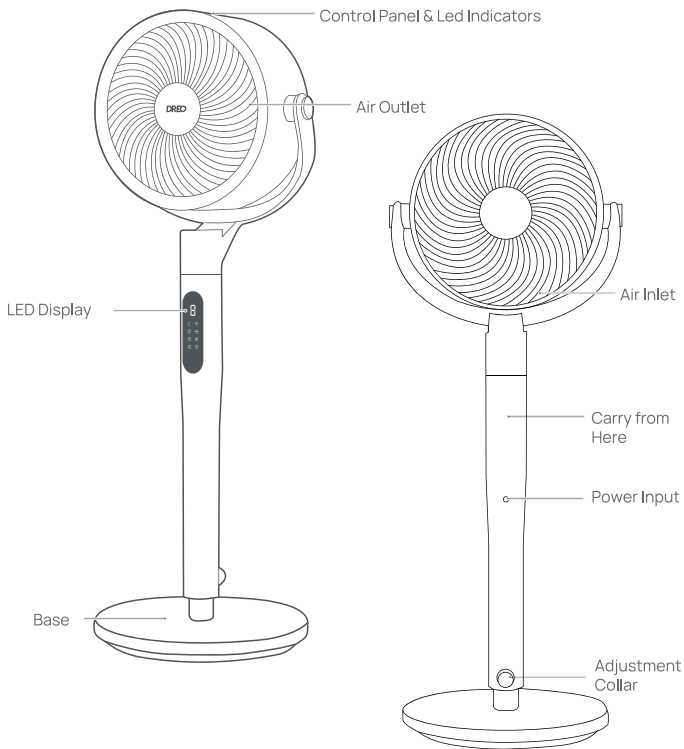

User Manual



Quick Start Guide



Remote Control (Battery Included)



Power Adapter

Flat Washer



Screw for Base



Screwdriver for Base



Screwdriver for Grilles

CONNECTING TO YOUR PEDESTAL AIR CIRCULATOR PolyFan 613S

03

This device includes the radio transmitting module whose CMIIT ID is FCC ID: 2A3SYMBL02.



Before connecting the appliance to your mobile device, please scan the QR code on the left or go to the app store and search “Dreo”, then select and download the app.





Look for “PolyFan 613S” when connecting your new pedestal air circulator fan.



You can use the Dreo app to connect your smart pedestal air circulator to **Amazon Alexa** or **Google Home**. Please follow the in-app instructions to set up your voice assistant.

NOTE: You must create a Dreo account to access voice assistants.

- 1 Launch Dreo and sign in or create account by following in-app instructions.
- 2 Enable Bluetooth on your mobile device and plug in your air circulator.
- 3 Hold the Oscillation button  for 5 seconds to start WiFi connection settings.
(Tip: The WiFi icon  will keep flashing when pairing.)
- 4 Tap **+ Add Device** and select **PolyFan 613S**.
- 5 Follow in-app instructions to complete WiFi connection.
- 6 You're now ready to control the appliance on your app.
(Tip: To restart connection settings, hold the Oscillation button  again for 5 seconds.)

KNOWING YOUR PEDESTAL AIR CIRCULATOR

04

Control Panel



Power Button

- Turn power on/off
- Long press 10 seconds to reset to factory settings



Increase Speed Button

- Increase airflow speed (1-8 levels)
- Exit Turbo or Custom Mode



Decrease Speed Button

- Decrease airflow speed (1-8 levels)
- Exit Turbo or Custom Mode



5s for WiFi

Horizontal Oscillation

- Sweep airflow horizontally (0°/60°/90°/120°)
- Long press 5 seconds to start network settings and device pairing



Vertical Oscillation

- Sweep airflow vertically (105°)
- Long press 3 seconds to mute/unmute

Note: This appliance is mute by default. To turn on button sounds, go to the Dreo app.

LED Display

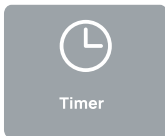

USING YOUR PEDESTAL AIR CIRCULATOR 05

Getting the Most out of Your Air Circulator

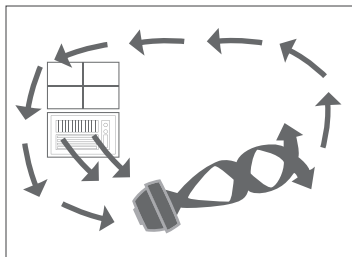

Summer:

Use with Air Conditioner

Position the air circulator in front of your AC to circulate cold air and provide better cooling.

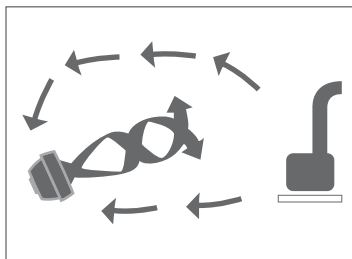

Winter:

Use with Heater

Send the heat to corner of the room and circulate warm air faster.

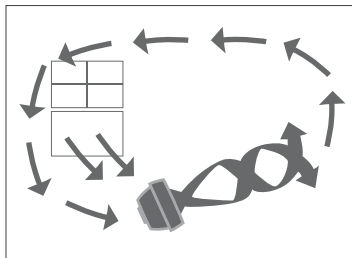

Spring & Fall:

Circulation

Make the indoors as fresh and pleasant as the outdoors.

General Operations

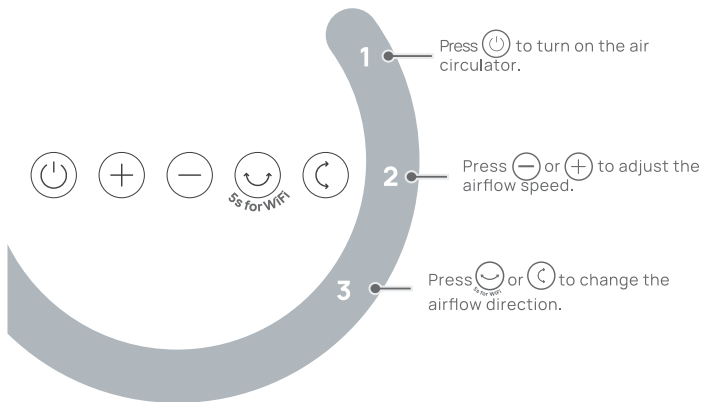

Working Modes (Press [list icon] on the remote)



Normal Mode

Air circulator runs at the fixed speed.



Auto Mode

Air circulator speed adapts to the ambient temperature.



Turbo Mode

Air circulator runs at the maximum speed.



Natural Mode (Available in the Dreo app)

Air circulator runs at alternating speeds.



Custom Mode (Available in the Dreo app)

Air circulator speed changes according to temperatures or time you desire.



Sleep Mode (Available in the Dreo app)

Mute auto on.
Air circulator speed decreases every 30 minutes.
Speed decreases by two levels at most and will remain constant if at level 3, 2, or 1:

For level 8: 8 → 7 → 6

For level 7: 7 → 6 → 5

For level 6: 6 → 5 → 4

For level 5: 5 → 4

For level 4: 4 → 3

For level 3: 3

For level 2: 2

Additional Features





Timer

When the fan is ON/OFF, touch the timer button  repeatedly to set a timer from 1 to 8 hours. When the timer ends, the fan will stop/start running automatically. To cancel, set the time to 0 hour.

Note: When the auto off timer is enabled, display will return to fan speed after 3 seconds. Display will show 8 if the timer is beyond 8 hours. To set a timer beyond 8 hours, please go to the Dreo app.



Child Lock

Long press the Horizontal Oscillation button  and Vertical Oscillation button  at the same time for 3 seconds to turn on/off Child Lock.

Note: Child Lock doesn't apply to operations from the remote control and the Dreo app. You can also turn off Child Lock by re-plugging in, resetting to factory settings, or through the Dreo app.



Memory

If the fan is turned OFF or disconnected from power, it will operate under the previous settings (except the Timer setting) when it is turned ON again.



Firmware Update

Check the firmware version on the Dreo app and update regularly for the air circulator to work more efficiently.

 Display will show "U" during the update process. Do not operate until the update is completed.



Display Auto Off

Display turns off after 1 minute (after 5 seconds in sleep mode). Wake up the display with any button.

To disable this feature, please go to the Dreo app.

Remote Control

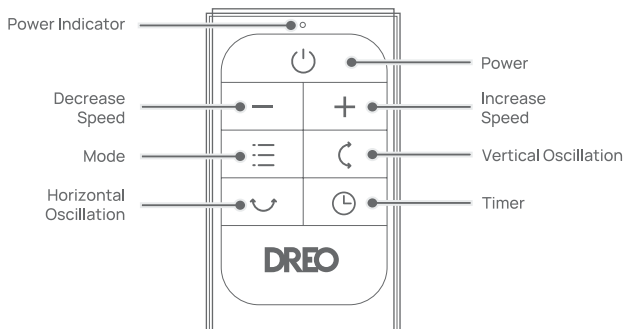

Battery Replacement

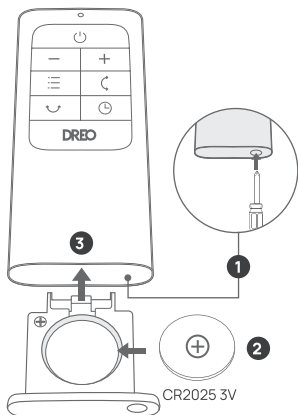

- 1** Press the locking button to pop out the battery holder.
- 2** Replace with the same battery type with the (+) side facing up.
- 3** Push in the holder until securely locked into place.

Note: If the indicator on the remote control doesn't turn on any more, please consider replacing the battery.



WARNING

- **INGESTION HAZARD:** This product contains a button cell or coin battery
- **DEATH** or serious injury can occur if ingested.
- A swallowed button cell or coin battery can cause Internal Chemical **Burns** in as little as **2 hours**.
- **KEEP** new and used batteries **OUT OF REACH of CHILDREN**
- **Seek immediate medical attention** if a battery is suspected to be swallowed or inserted inside any part of the body.



- a) Remove and immediately recycle or dispose of used batteries according to local regulations and keep away from children. Do NOT dispose of batteries in household trash or incinerate.
- b) Even used batteries may cause severe injury or death.
- c) Call a local poison control center for treatment information.
- d) Compatible battery type: CR2025.
- e) Battery nominal voltage: 3.0 Vdc
- f) Non-chargeable batteries shall not be recharged.
- g) Do not force discharge, recharge, disassemble, heat above (rated temperature: 140°F) or incinerate. Doing so may result in injury due to venting, leakage or explosion resulting in chemical burns.
- h) Ensure the batteries are installed correctly according to polarity (+ and -).
- i) Do not mix old and new batteries, different brands or types of batteries, such as alkaline, carbon-zinc, or rechargeable batteries.
- j) Remove and immediately recycle or dispose of batteries from equipment not used for an extended period of time according to local regulations.
- k) Always completely secure the battery compartment. If the battery compartment does not close securely, stop using the product, remove the batteries, and keep them away from children.

CLEANING AND MAINTENANCE

06

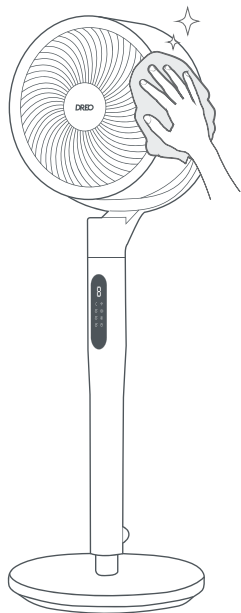

Outer Surface

Gently wipe off the dust with a soft, dry cloth.

Base

The base can be disassembled in the reverse order of assembly.

CAUTION



1. Always unplug the fan before any cleaning or maintenance to avoid the risk of fire, electric shock, or injury to persons.
2. Do not immerse in water or get water inside the motor housing.
3. Do not use any chemical agents when cleaning the fan.
4. Store in a cool, dry place and cover it to protect from dust.

Grilles



WARNING

To reduce the risk of electrical shock and injury to persons, turn off and unplug the appliance before any cleaning and maintenance.

1

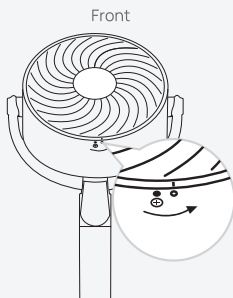

Front

Rear

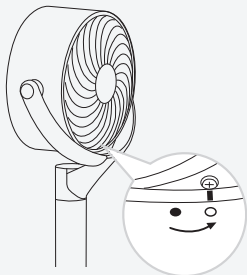

Remove the screws on the front and rear grilles, rotate the grilles counterclockwise to take them off.

2

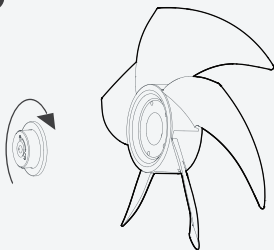

Remove the blade cap by rotating it as shown and take the blade assembly out of the shaft.

3

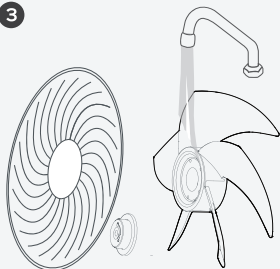

Rinse cap, blades, and grilles under running water or with a clean, damp cloth.

4

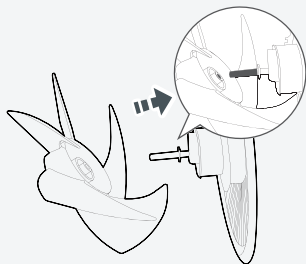

Dry up all parts, and insert the blade assembly back into the shaft by aligning the D-shaped points on the center.

5

Front

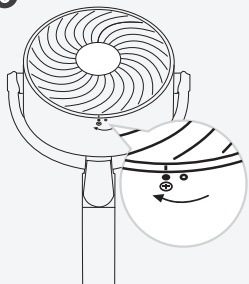

Rear

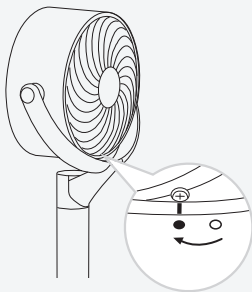

Align the point on the front grille with the right point on the casing, then rotate the grille clockwise and install the screw back in place. Repeat the steps for the rear grille.

My air circulator won't turn on!

Make sure that the cord is connected to a powered outlet and the mains voltage corresponds with the voltage indicated on the air circulator.

My air circulator is shaky and wobbling!

1. Place the air circulator on a flat, level surface.
2. Incorrect installation might also cause shakiness. Please refer to the assembly instructions in **page 4-5**.

My air circulator is making vibration and noise!

1. Place the air circulator on a flat, level surface.
2. Be sure not to insert anything into the air inlet and outlet.

If your problem is not listed or still persists, please contact our Customer Support (**see page 20**)

DREO CUSTOMER CARE

08

Default 12-Month Warranty

This appliance is covered by Dreo warranty for 12 months from the date of its original purchase.

The warranty will not apply in cases of:

1. Accident, misuse, or repairs performed by unauthorized personnel.
2. Any unit that has been tampered with or used for commercial purposes.
3. Normal wear and tear of wearable parts.
4. Use of force, damage caused by external influences.
5. Damage caused by non-observance of the User Manual, e.g. connection to an unsuitable mains supply or noncompliance with the instructions.
6. Partially or completely dismantled appliances.
7. Defects caused by or resulting from damages from shipping or from repairs, service, or alteration to the product or any of its parts that have been performed by a repair person not authorized by Dreo.

We can only provide after-sales service for products that are sold by Dreo or Dreo authorized retailers and distributors. If you have purchased the appliance from a different place, please contact your seller for return and warranty issues.

FCC STATEMENT

This device complies with Part 15 of the FCC Rules.

This equipment has been tested and found to comply with the limits for a Class B digital device, pursuant to Part 15 of the FCC Rules. These limits are designed to provide reasonable protection against harmful interference in a residential installation. This equipment generates, uses and can radiate radio frequency energy and, if not installed and used in accordance with the instructions, may cause harmful interference to radio communications. However, there is no guarantee that interference will not occur in a particular installation.

Please note that changes or modifications of this product is not expressly approved by the party responsible for compliance could void the user's authority to operate the equipment. If this equipment does cause harmful interference to radio or television reception, which can be determined by turning the equipment off and on, the user is encouraged to try to correct the interference by one or more of the following measures:

- Reorient or relocate the receiving antenna.
- Increase the separation between the equipment and receiver.
- Connect the equipment into an outlet on a circuit different from that to which the receiver is connected.
- Consult the dealer or an experienced radio/TV technician for help.

This device complies with Part 15 of the FCC Rules. Operation is subject to the following two conditions: (1) this device may not cause harmful interference, and (2) this device must accept any interference received, including interference that may cause undesired operation.

This equipment complies with FCC radiation exposure limits set forth for an uncontrolled environment. End users must follow the specific operating instructions for satisfying RF exposure compliance. To maintain compliance with FCC RF exposure compliance requirements, please follow operation instructions as documented in this manual. This transmitter must not be co-located or operating in conjunction with any other antenna or transmitter. This equipment should be installed and operated with a minimum distance of 20cm between the radiator and your body. The availability of some specific channels and/or operational frequency bands are country dependent and are firmware programmed at the factory to match the intended destination. The firmware setting is not accessible by the end user.

Model No.: DBAF03S
Rev_1.0_EN

We're Here to Help!

 (888) 290-1688 Mon-Fri, 9:00 am-5:00 pm PST/PDT

 support@dre0.com

 www.dre0.com

 Hesung Innovation Corp

 377 Valley Rd, Unit #2686, Clifton, NJ 07013 U.S.A.



MADE IN CHINA



Intertek