

DREO

PTC Fan Heater
Atom 320

USER MANUAL

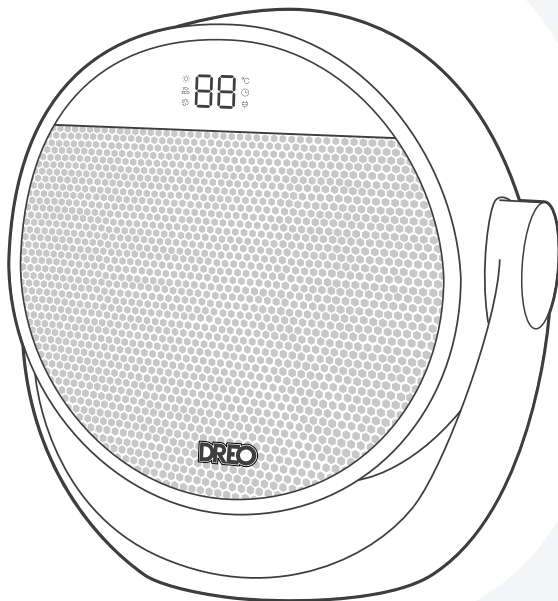

The device is only suitable for well insulated spaces or occasional use.

//

Thanks for Choosing **DREO!**

Your support means the world to us.
We hope you enjoy our product as much as
we did creating it.

CONTENT

01

IMPORTANT SAFETY
INSTRUCTIONS

1-4

02

KNOWING YOUR
APPLIANCE

5

03

USING YOUR APPLIANCE

6-10

04

CLEANING AND
MAINTENANCE

11-12

05

TROUBLESHOOTING

13-14

06

DREO CUSTOMER CARE

15-18

IMPORTANT SAFETY INSTRUCTIONS

01



When using electrical appliances, basic precautions should always be followed to reduce the risk of fire, electric shock, and injury to persons and hyperthermia, including the following:



WARNING:

In order to avoid overheating, do not cover the heater.

Do not use the fan heater near flammables and combustibles.

General Safety

1. This appliance is not intended for use by persons (including children) with reduced physical, sensory or mental capabilities, or lack of experience and knowledge, unless they have been given supervision or instruction concerning use of the appliance by a person responsible for their safety.
2. Children should be supervised to ensure that they do not play with the appliance.
3. This appliance can be used by children aged from 8 years and above and persons with reduced physical, sensory or mental capabilities or lack of experience and knowledge if they have been given supervision or instruction concerning use of the appliance in a safe way and understand the hazards involved. Children shall not play with the appliance. Cleaning and user maintenance shall not be made by children without supervision.
4. Children of less than 3 years should be kept away unless continuously supervised.

5. Children aged from 3 years and less than 8 years shall only switch on/off the appliance provided that it has been placed or installed in its intended normal operating position and they have been given supervision or instruction concerning use of the appliance in a safe way and understand the hazards involved. Children aged from 3 years and less than 8 years shall not plug in, regulate and clean the appliance or perform user maintenance.
6. If the supply cord is damaged, it must be replaced by the manufacturer, its service agent or similarly qualified persons in order to avoid a hazard.
7. **CAUTION:** In order to avoid a hazard due to inadvertent resetting of the thermal cut-out, this appliance must not be supplied through an external switching device, such as a timer, or connected to a circuit that is regularly switched on and off by the utility.
8. The heater must not be located immediately below a socket outlet.
9. Do not use this heater in the immediate surroundings of a bath, a shower or a swimming pool.
10. Do not use this heater if it has been dropped.
11. Do not use if there are visible signs of damage to the heater.
12. Use this heater on a horizontal and stable surface, or fix it to the wall, as applicable.
13. **WARNING:** Do not use this heater in small rooms when they are occupied by persons not capable of leaving the room on their own, unless constant supervision is provided.
14. **WARNING:** To reduce the risk of fire, keep textiles, curtains, or any other flammable material a minimum distance of 1 m from the air outlet.
15. **CAUTION** — Some parts of this product can become very hot and cause burns. Particular attention has to be given where children and vulnerable people are present.

Usage Safety

1. Use the handle to move this heater.
2. Do not insert or allow foreign objects to enter any ventilation or exhaust opening as this may cause an electric shock or fire, or damage the heater.

3. Do not attempt to modify or repair the product by yourself. Doing so could void the warranty and cause damage or personal injury. Only a repair technician may disassemble or repair this product.
4. Make sure that no pieces of polystyrene or other packaging material have been left between elements of the appliance. It may be necessary to pass over the appliance with a vacuum cleaner.
5. If the machine is not working as it should, has received a sharp blow, has been dropped, damaged, left outdoors, or dropped into water, do not use and contact Customer Support.
6. There may be a trace of smoke or odor when the unit is first operated. This indicates that a drop of oil fell on the heating coil during the manufacturing process. It will quickly evaporate and should not re-occur.

Location Safety

1. Do not use outdoors.
2. A heater has hot and arcing or sparking parts inside. Do not use it in areas where gasoline, paint, or flammable liquids are used or stored.
3. To prevent possible fire, do not block air intakes or exhaust in any manner. Do not use on soft surfaces, like a bed, where openings may become blocked.

Electricity Safety

1. Always unplug the heater when not in use.
2. Do not operate any heater with a damaged cord or plug or after the heater malfunctions, has been dropped or damaged in any manner. Discard heater, or return to authorized service facility for examination, and/or repair.
3. Do not run cord under carpeting. Do not cover cord with throw rugs, runners, or similar coverings. Do not route cord under furniture or appliances. Arrange cord away from traffic area and where it will not be tripped over.
4. To disconnect heater, turn controls to off, then remove plug from outlet.
5. Always plug heaters directly into a wall outlet/receptacle.
6. Never use with an extension cord or relocatable power tap (outlet/power strip).
7. If there is a loose fit between the plug and the socket or the plug becomes very hot, the socket may need to be replaced. Check with a qualified electrician to replace the socket.

- It is normal for the plug and cord to feel warm to the touch.
- A plug or cord which becomes hot to the touch or becomes distorted in shape may be a result of a worn electrical outlet. Worn outlets or receptacles should be replaced prior to further use of the heater. Plugging the heater into a worn outlet/receptacle may result in overheating of the power cord or fire.

DANGER - High temperatures may be generated under certain abnormal conditions.

Do not partially or fully cover or obstruct the front of this heater.

FOR HOUSEHOLD USE ONLY READ AND SAVE THESE INSTRUCTIONS

Gentle Reminder:



Check the appliance regularly and refer to TROUBLESHOOTING or contact our customer support if it shows any of the following signs:

- Power cord or plug is damaged.
- Loud noise, unusual smell or excessive heat.

Specifications

Model No.	DR-HSH020
Rated Power	1500W
Input	220-240V~50Hz

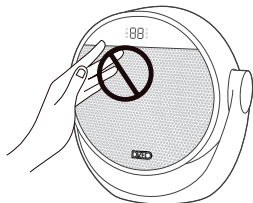

HOT SURFACE

THE FRONT SURFACE CAN BE VERY HOT DURING USE.
DO NOT TOUCH WHEN IN USE.

KNOWING YOUR APPLIANCE

02

Package Contents

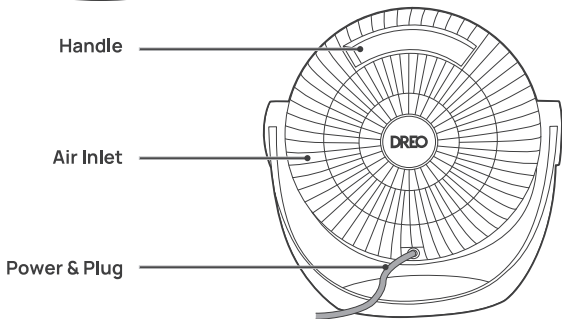
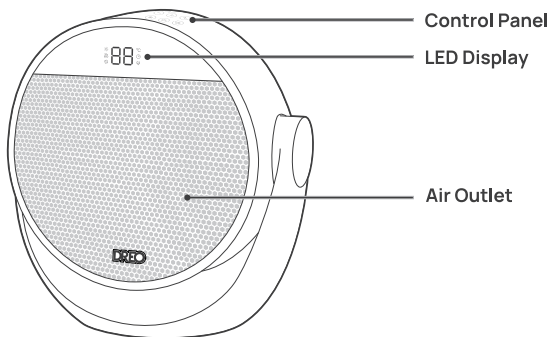

Remote Control
(battery included)

USING YOUR APPLIANCE

03

Control Panel



Power Button

Touch to turn the heater on or off.

Note:

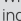
When the heater is plugged into the electric outlet, the power indicator  will light in red.

Once turned off, a 30-second countdown will show up on the display as the fan will continue to run for 30 seconds to blow out the remaining heat.



Mode Button

Touch to switch between  →  → 

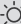
 Power heat with three heating levels:
H1 (900W), H2 (1300W), H3 (1500W).

 The heater will automatically select its optimal heating power, depending on the difference between the set temperature (5-35°C) and ambient temperature.

Note:

- When the ambient temperature reaches the set temperature, the heater will stop heating automatically in 30 seconds.
- When the ambient temperature drops below the set temperature, the heater will operate on low or high power (900W or 1500W), depending on the difference between the two temperatures.

 Fan only mode with three speed levels: F1, F2, F3.

LED Display ON/OFF

Long press for 3 seconds to turn on/off the LED display.



Timer Button

- When the heater is on, touch to set a timer (0-12h)
After the timer ends, the heater will turn off automatically.
- To cancel, set the timer to 0 hour.



Mute Button

Press  on the control panel to turn on/off the button sounds.



Heat Level/Temperature Buttons

- In Power Heat Mode, touch \oplus or \ominus to adjust the heating level.
- In ECO mode, touch \oplus or \ominus to adjust the set temperature.
- In Fan only mode, touch \oplus or \ominus to adjust the fan speed level.

Note:

In ECO mode, the heater will turn off automatically when the set temperature has been reached. If your heater turns off frequently please raise the set temperature, or switch to Power Heat mode.

Child Lock

Long press \oplus and \ominus for 3s to activate / deactivate the Child Lock function, when activated, the display will show "LC", and all the buttons on the space heater will be locked.

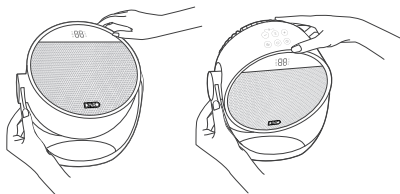

Warning: Hold the bottom or side of the base while adjusting the heater angles to prevent accidental contact with the control panel or the air outlet.

LED Display



Power Heat



ECO Mode



Fan Only



Timer



Heat Level / Timer Hour /
Set Temperature



Plugged In

More Features

Turn on/off the LED Display by using the remote control.

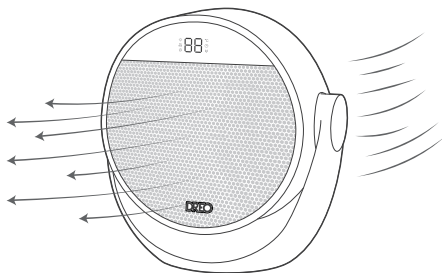

Memory

If the heater is turned OFF or disconnected from power, it will operate under the previous settings (except the Timer setting) when it is turned ON again.



Tip-over Protection

When the heater is tipped over, it will shut off automatically with the error code "P4" on the display.



24-Hour Auto Off

This feature is not ON by default. When this feature is ON, the heater will shut off automatically after continuously running for 24 hours. Long press the Timer button for 3 seconds to turn this feature ON/OFF when this heater is on standby. The display will show "00" and "0F" respectively.



Overheat Protection

When the heater overheats, it will shut off automatically with the error code "FF" on the display.



LED Display On/Off

Turn on/off the LED Display by using the remote control.

Remote Control

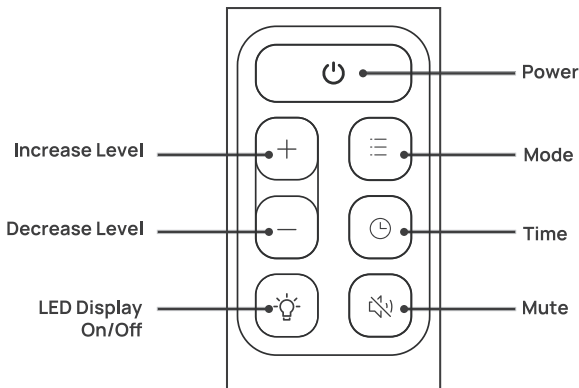

Battery Replacement

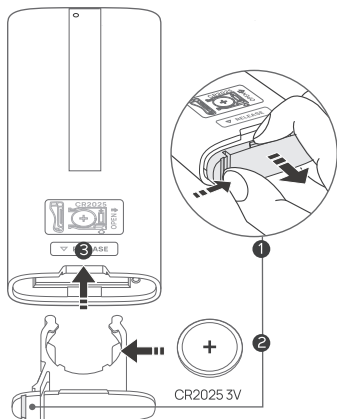

- 1 Keep the locking tab pressed while pulling out the battery holder from the slot at the back.
- 2 Replace with the same battery type with the (+) side facing up.
- 3 Push in the holder until securely locked in place.

Note: If the appliance doesn't respond when using the remote control in close range, please consider replacing the battery.

BATTERY WARNING

KEEP OUT OF REACH OF CHILDREN
Swallowing can lead to chemical burns, perforation of soft tissue, and death. Severe burns can occur within 2 hours of ingestion. Seek medical attention immediately.



No obvious symptoms from battery ingestion. Unfortunately, it is not obvious when a button or coin battery is stuck in a child's oesophagus (food pipe). There are no specific symptoms associated with this. The child might:

- cough, gag or drool a lot; appear to have a stomach upset or a virus;
- be sick;
- point to their throat or stomach;
- have a pain in their abdomen, chest or throat;
- be tired or lethargic; be quieter or more clingy than usual or otherwise "not themselves";
- lose their appetite or have a reduced appetite; and
- not want to eat solid food / be unable to eat solid food.

These sorts of symptoms vary or fluctuate, with the pain increasing and then subsiding. A specific symptom to button and coin battery ingestion is vomiting fresh (bright red) blood. If the child does this seek immediate medical help. The lack of clear symptoms is why it is important to be vigilant with "flat" or spare button or coin batteries in the home and the products that contain them.

CLEANING AND MAINTENANCE

04

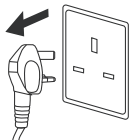

Always turn off and unplug before cleaning.



Outer Surface

Gently wipe off the dust with a soft, dry cloth.

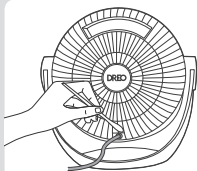

Air Inlet

Use a soft, dry cloth or a cotton-tipped swab to remove any dust from the air inlet.

ATTENTION



DO NOT unscrew the unit.



DO NOT use cleaning agents.



DO NOT use abrasive scrubbers.

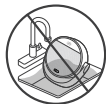

Fire or electrical shock hazard.
DO NOT immerse the main unit in water.
NEVER allow water to get inside the heater.



Except for cleaning, any servicing should be performed by an authorized service representative.



Store in a cool, dry area and keep the cable out of high-traffic areas to avoid tripping hazards.



Correct Disposal of this product

This marking indicates that this product should not be disposed of with other household waste throughout the EU. To prevent possible harm to the environment or human health from uncontrolled waste disposal, recycle it responsibly to promote the sustainable reuse of material resources. To return your used device, please use the return and collection system or contact the retailer where the product was purchased. They can take this product for environmentally safe recycling.

TROUBLESHOOTING 05

Problem	Possible Causes	Solution
Malfunction codes on LED display	E2 - Temperature sensor short circuit	Unplug it from the power source and contact Customer Support.
	E1 - Temperature sensor open circuit	Unplug it from the power source and contact Customer Support.
	FF - Overheat protection	Unplug and wait for it to cool down before plugging in again.
	P4 - Tip-over protection	Place the heater back on a flat, level and stable surface.
Heater does not start	Power cord is not properly plugged in.	Connect the plug to a powered electrical outlet.
	Overheat protection has been activated.	Unplug and wait for it to cool down before plugging in again. Remove any objects on or near the heater.

Heater does not start	No power is passing through the unit.	Ensure that your circuit breaker or fuse is working properly.
		Ensure that your heater is placed on a flat and even surface.
	The set temperature is lower than the ambient temperature.	Ensure that the temperature is set to be higher than the ambient temperature.
The heater suddenly stops during heating	The temperature exceeds the threshold of the thermal cutoff.	Turn off and unplug the unit. Allow it to cool and plug into the electrical outlet again.
	The heater is tipped over.	Place it on a flat, level and stable surface.
	In ECO mode, the heater will turn off automatically when the set temperature has been reached.	This is normal. If your heater turns off frequently, please raise the set temperature, or switch to Power Heat mode.

If your problem is not listed or still persists, please contact our Customer Support (see page 18).

DREO CUSTOMER CARE

06

24-MONTH LIMITED WARRANTY

What is Covered

DREO warrants to you that your product will be free from original defects in materials and workmanship for a period of twenty four (24) months from the date of your purchase, when you use your product for intended purposes in accordance with this User Manual.

Please retain your proof of purchase. If you do not retain your proof of purchase, your warranty will start two (2) months from the date of manufacture printed on your product label.

What is Not Covered

This limited warranty only applies to the original purchaser of your product and is non-transferable. This warranty is only valid if your product is used in the country in which you originally purchased it. In addition, this warranty will not apply, and DREO will not be liable for any costs, damages, or repairs, in connection with any of the following:

- Accidents or use of your product with inappropriate force;
- Damage or destruction caused by wrong voltage or unstable electric current;
- Normal wear and tear;
- Careless operation or handling, misuse, abuse, neglect, and/or failure to maintain or use your product in accordance with this User Manual;
- Any partially or completely altered, modified and/or dismantled products;
- Reduction in battery discharge time due to battery age or use (as applicable);
- Products with altered or removed serial numbers;
- Clearing any blockages from the product;
- Purchases from retailers and distributors not authorized by DREO to sell this product;
- Defects caused by or resulting from damages from shipping or handling by any third party not authorized by DREO to ship or handle your product; or
- Defects caused by or resulting from repairs, service, improper maintenance, or alteration to your product or any of its components by anyone other than a repair person authorized by DREO.

Any service and customer support that DREO provides to you under this limited warranty will not extend the duration of this limited warranty.

Warranty Limitations and Exclusions

ANY IMPLIED WARRANTIES RELATING TO YOUR PRODUCT, INCLUDING BUT NOT LIMITED TO THE WARRANTY OF MERCHANTABILITY AND THE WARRANTY OF FITNESS FOR A PARTICULAR PURPOSE, ARE LIMITED TO THE DURATION OF THE LIMITED WARRANTY SET FORTH ABOVE AND ARE OTHERWISE DISCLAIMED.

THIS LIMITED WARRANTY SHALL BE THE SOLE REMEDY OF THE PURCHASER OR USER OF THE PRODUCT, AND DREO SHALL NOT BE LIABLE FOR AN ALLEGEDLY DEFECTIVE OR DAMAGED PRODUCT EXCEPT TO REPAIR OR REPLACE IT IN ACCORDANCE WITH THIS LIMITED WARRANTY. DREO WILL NOT BE LIABLE FOR SPECIAL, INCIDENTAL, INDIRECT, CONTINGENT, OR CONSEQUENTIAL DAMAGES OR LOSSES OF ANY NATURE THAT YOU MAY INCUR IN CONNECTION WITH YOUR PURCHASE OR USE OF YOUR PRODUCT.

Some jurisdictions do not allow limitations on how long an implied warranty lasts or the exclusion or limitation of incidental or consequential damages, so the above limitations or exclusions may not apply to you. This limited warranty gives you specific legal rights, and you also may have other rights which vary from jurisdiction to jurisdiction.

Limited Remedies

If your product fails because of an original defect in material and/or workmanship during the warranty period, DREO will repair or replace (in DREO's sole discretion) your product.

To obtain warranty service on your product, contact us at uk-support@dreo.com for further instructions.

IN THE EVENT OF AN ORIGINAL DEFECT IN MATERIAL AND/OR WORKMANSHIP, TO THE EXTENT PERMITTED BY LAW, THE REMEDIES SET FORTH IMMEDIATELY ABOVE ARE YOUR SOLE AND EXCLUSIVE REMEDIES.

Item	Symbol	Value	Unit	Item	Unit
Heat output				Type of heat input, for electric storage local space heaters only (select one)	
Nominal heat output	P_{nom}	1.5	kW	manual heat charge control, with integrated thermostat	No
Minimum heat output(indicative)	P_{min}	1.0	kW	manual heat charge control with room and/ or outdoor temperature feedback	No
Maximum continuous heat output	$P_{max,c}$	1.5	kW	electronic heat charge control with room and/or outdoor temperature feedback	No
Auxiliary electricity consumption				fan assisted heat output	No
At nominal heat output	eI_{max}	0.000	kW	Type of heat output/room temperature control (select one)	
At minimum heat output	eI_{min}	0.000	kW	single stage heat output and no room temperature control	No
In standby mode	eI_{sb}	0,00046	kW	Two or more manual stages, no room temperature control	No
				with mechanic thermostat room temperature control	No
				with electronic room temperature control	Yes
				electronic room temperature control plus day timer	No
				electronic room temperature control plus week timer	No
				Other control options (multiple selections possible)	
				room temperature control, with presence detection	No
				room temperature control, with open window detection	No
				with distance control option	No
				with adaptive start control	No
				with working time limitation	Yes
				with black bulb sensor	No
Contact details	Refer to Applicant Name: Shenzhen Hesung Innovation Technology Co., LTD. Address: 26F, Bldg A7, Creative City, Shenzhen, China.				

Model No.: DR-HSH020
Rev_1.1_UK

We're Here to Help!

 uk-support@dreo.com

 www.dreo.com

 Shenzhen Hesung Innovation Technology Co., LTD

 26F, Bldg A7, Creative City, Shenzhen, China



MADE IN CHINA

www.dreo.com

Looking for help?

Contact us to get expert support.



uk-support@dreo.com



www.dreo.com